

A21512U

SUPERIOR SERIES



>>> OVERALL FEATURES

- > Long-range RFID UHF reader with IP67 protection rate for harsh environment
- > Designed and created to operate in harsh and hostile environments
- > Die-cast aluminium robust casing
- > Standard 5-pole M12 industrial connectors
- > Ultra compact, easy installation, simple use
- > Designed and produced in Italy
- > Certifications: CE, RoHS, Reach



>>> APPLICATIONS



DATA COLLECTION



INDUSTRY 4.0



LOGISTICS



INDUSTRIAL
AUTOMATION



WASTE MANAGEMENT

The new family of Industrial UHF RFID readers, called Superior, guarantees robustness, compactness, protection and flexibility. Versions with integrated antenna or up to 4 external antennas available. They are ideal for RFID automatic identification, access control, industrial automation, waste management, IoT applications. Available with wide power supply (8-30V), I/O management and various types of interfaces, such as RS232, RS485, Ethernet, Ethernet PoE

>>> EXAMPLE OF DATA COLLECTION IN THE INDUSTRIAL AREA

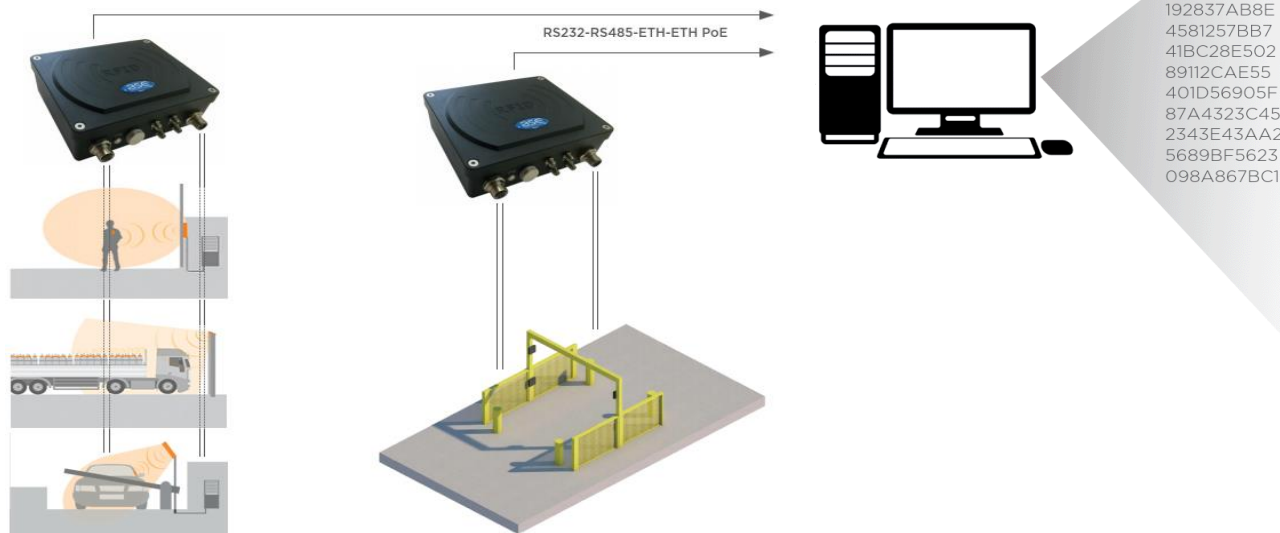

TECHNICAL FEATURES

Supported tags	ISO18000-6C and EPC Class1 Gen2 tags	
Operative frequency	860-940MHz	
Antenna	integrated antenna or up to 4 external antennas managed in multiplex Integrated antenna with circular polarization and 5.5 dBi gain Antenna protection and auto-tuning circuit	
Power	≤ 30dBm adjustable via software	
Reading distance	typ. 10 meters , up to 20 meters (depends on tag and antenna)	
Functions	FHSS / Fixed Frequency / RSSI / DRM / Buffer	
Working mode	Spontaneous, polling, trigger, buffer, DRM, EPC/TID/EPC+TID inventory	
Interface	RS232, RS485, Ethernet TCP/IP, Ethernet TCP/IP PoE, Wiegand	
Power supply	8-30Vcc - max 35Vcc max 650mA (@ 1Watt RF) reverse polarity protection	
Input and output	1x relay, led, buzzer, 1x trigger input, software adjustable Relay contacts : 0,5A @ 125 VAC - 1A @ 24 VDC	
Size	148x125x41mm	
Temperature	Operative -20°C ÷ +70°C	Storage -20°C ÷ +80°C
Protection rate	IP67	
Weight	1100g	
Accessories	Mounting kit with wall and pole brackets, SDK, demo software	
Extras	Wide range of UHF antennas for different applications Available with integrated antenna Output string with CRC check Pressure compensation circular vent Reading functions: EPC, TID, EPC+TID or User Memory	

VERSIONS

Code	Version	Picture
A21512U-xx	Industrial IP67 high performance reader	
1	1x integrated antenna	
2	1x integrated antenna + 1x external antenna	
5	1x external antenna	
7	4x external antenna	
Interface		
A	RS232 + Wiegand	
B	RS485	
C	Ethernet TCP/IP	
D	PoE	

STANDARD FUNCTIONALITY

Function	Description
Antenna management	up to 4 external antennas
Antenna tests	Antenna efficiency test circuit with protection when threshold is exceeded
Antenna alarm threshold	Adjustable via software
Supported tags	Standard Iso18000-3 EPC GEN2 including QT type (public/private EPC)
Opto-isolated inputs	Opto-isolated external trigger input, manageable via software
Trigger	Active high/low
Relay output	Relay with closing contact (normally open), manageable via software Relay activated automatically at each tag reading
Working mode	Spontaneous, Polling, Trigger H, Trigger L, Dense Read Mode
Interfaces	RS232, RS485, Ethernet TCP/IP, Wiegand
Baud-rate	Selectable from 9600 to 115200 (default 57600)
Writing functions	Writing data blocks with Access password and Kill password management
Reading functions	EPC, TID, EPC+TID, USER, with/without 1sec delay, with/without CR-LF String options, selectable via software
Scan Time	Software adjustable
Address	Each reader can be addressed from 0 to 255
Code filter	Selectable from 1-1800 sec (30 min), up to 200 codes, with FIFO mode
Firmware	Remotely upgradeable
Power supply	8 - 30 Vdc with electrical protections
Power RF	0-30 dBm selectable by software, in steps of 1 dBm
Frequency band	5 frequency bands selectable via software; China-Korea-US-EU-EU3



ADDED FUNCTIONALITY V7.5

Function	Description
Timed input	Status acquisition delay, settable via software
Optical indications	LED with logic and timing selectable by software
Buzzer	Buzzer with logic and timing selectable by software
Code buffer	Code buffer up to 100 x 128 bit codes

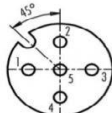
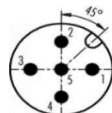
CONNECTION

COM M12 5P F	ETH	RS485	RS232	COLORI	POW	POW M12 5P M
<i>Female insert M12</i> 	1 NC	+5V	DATA1 (WGD)	MAR	VCC	<i>Male insert M12</i> 
2 TX+	D-		RXD (RS232)	BIA	IN1	2
3 RX+	GND		GND	BLU	GND	3
4 TX-	D+		TXD (RS232)	NER	RELE	4
5 RX-	GND		DATA0 (WGD)	GRI	RELE	5

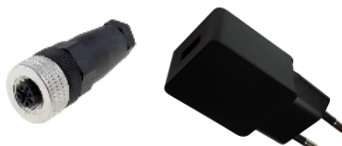
ACCESSORIES

Codice	Versione	Immagine
AA101	M12 5P F connector to wire for POW	
AA102	M12 5P M connector to wire for COM	
AA103	2m M12 5P F cable - wires for POW	
AA104	2m M12 5P M cable - wires for COM	
AA105	2m M12 5P M cable - DB9 for COM	
AA107	2m M12 5P M -RJ45 Crossed Cable for ETH	
AA108	2m M12 5P M -RJ45 Straight cable for ETH	
AA501	AC/DC power supply 220V-12V3A with M12 connector	
AA502	AC/DC power supply 220V-24V3A with M12 connector	
AA503	AC/DC power supply 220V-9V3A with M12 connector	
AA803	Wall bracket + screw kit	
AA802	Pole bracket + screw kit	

OPTIONS AVAILABLE

Versions with single M12 connector (no ETH)
Customized versions

CERTIFICATIONS

EN301489-1-17	EMC
EN302208	Radio
EN62311	Exposure
EN60950-1	Safety
RoHS	Dangerous substances
EN300220-1-2	Electromagnetic compatibility
Complies with the new RED regulations in force since 13 June 2017	



OTHER PICTURES



Top view



Front view



Pole bracket

Notes: reading and writing distances, carried out with isocard format tags, 30dBm power, 8dBi antenna
Specifications subject to change without notice